

45 BIRCH AVENUE, TORONTO

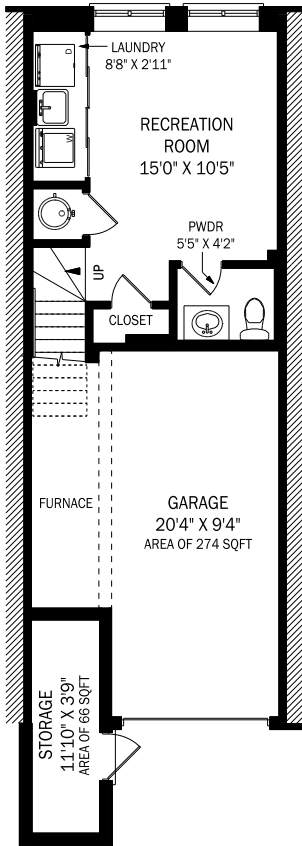

LOWER LEVEL - 279 SQUARE FEET

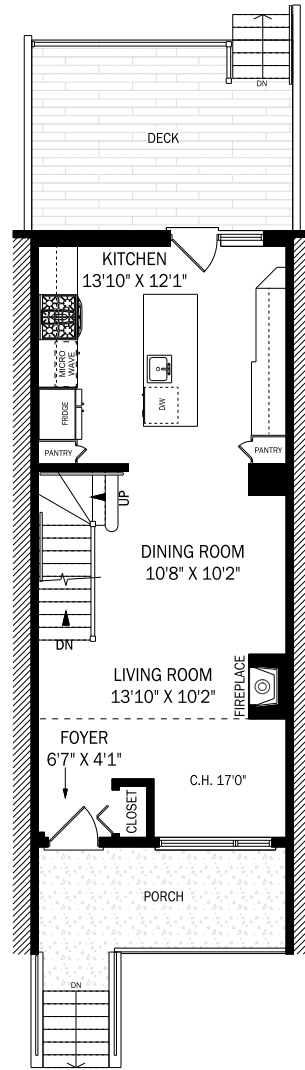

CEILING HEIGHT 8'0"
MAIN FLOOR - 500 SQUARE FEET

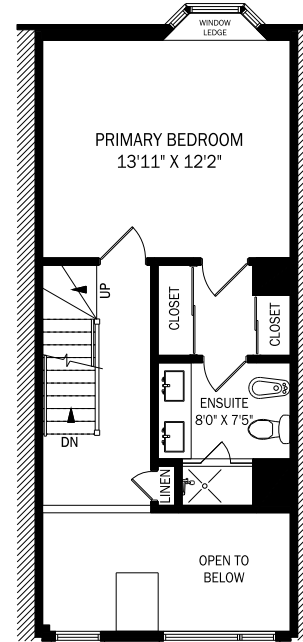

CEILING HEIGHT 8'0"
SECOND FLOOR - 414 SQUARE FEET



AREA EXCLUDES 90 SQ. FT.
OPEN TO BELOW SPACE

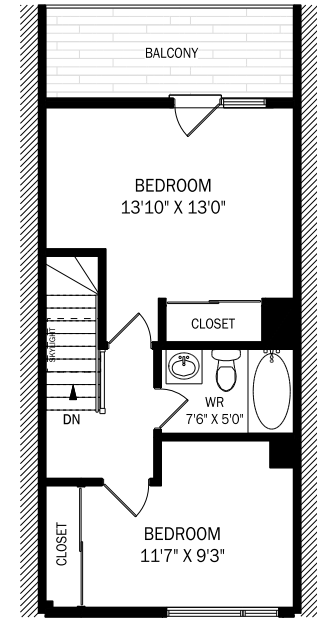

CEILING HEIGHT 8'0"
THIRD FLOOR - 421 SQUARE FEET

